

 UNIONMAIN
HOMES

WAXAHACHIE, TX



We Can See
YOU *at*



**MYRTLE
CREEK**



MYRTLE CREEK

Waxahachie, Texas



Welcome home to Myrtle Creek, our newest premier, master-planned community nestled in the heart of Waxahachie, Texas. This thoughtfully designed community features scenic green spaces, natural trails, and a future on-site elementary school, making it the perfect place for your family to grow and thrive.

Residents of Myrtle Creek will enjoy elevated living with spacious homesites and beautifully crafted homes that offer a variety of stylish interior and exterior design options to personalize your dream home. Life here goes far beyond your front door, with plans for resort-style amenities, miles of hike-and-bike trails, pocket parks, and open green spaces that invite connection with nature and neighbors alike.

Myrtle Creek is ideally located just off Highway 287 and FM 878, providing convenient access to I-35E and Highway 77. You're just minutes from historic Downtown Waxahachie and within easy reach of the area's top dining, shopping, and entertainment. With access to highly rated Waxahachie ISD schools and a community environment designed to bring people together, Myrtle Creek offers the perfect blend of comfort, convenience, and charm.

BUILDING AN EXTENSION OF
YOU

We see your life story as the blueprint for your perfect home, so our team builds with **YOU** at the heart of each plan. Beginning with a framework that reflects your family values, constructing spaces that support your growth and dreams, and finishing with the details that make it uniquely your own. Every brick, beam and brushstroke is *yours*.

SMALL-TOWN LIFE

Explore the 20-block historic downtown in the heart of Waxahachie. There's plenty of things to do in this charming district of preserved historic buildings:

- Shop small businesses
- Wine & dine at local spots
- Attend monthly events



TOP-TIER EDUCATION

Parents that join the Myrtle Creek community can rest assured that their children will receive an exemplary education throughout the course of their academic journey. Waxahachie ISD continues to experience steady growth in student enrollment and consistently earns high ratings, making it a strong selling point for families relocating to the area. The district is proud to maintain excellent academic and special education programs, champion athletics, distinguished fine arts, and the best of the best facilities. Waxahachie ISD and its team of dedicated professionals are passionate about coaching your kids to strive for success and embody all-around greatness.

UNIONMAIN

Sitemap



With spacious, modern floor plans, Myrtle Creek has a home for every taste and lifestyle. Our highly personalized homebuying process allows each family to customize their ideal space with upgrade options that meet both wants and needs.

SELECT COLLECTION

- 2,224 - 3,948 SqFt
- 3 - 5 Beds
- 2 - 4.5 Baths
- 2 - 3 Car Garages
- Home Office / Study in Select Home Designs
- Media Room / Loft in Select Home Designs



SCHOOL DISTRICT

- Ray Elementary School (K-5)
- Howard Middle School (6-8)
- Waxahachie High School (9-12)

BELTON

PLAN #B5110 | 2,224 SQFT



3 Bed



2 Bath



1 Story



2-3 Garage

UPGRADE OPTIONS:

Half Car Garage/Single Door Option, Pedestrian Garage Door, Extended Outdoor Living, 9-12' Sliding Doors, Indoor Center/Corner Fireplace, Super Shower, Primary Bath Barn Doors, Tray Ceilings at Primary Suite/Foyer, Cabinet and Sink at Laundry, Primary Closet Door to Laundry, Mud Bench, Additional Dining Windows, Radial Kitchen Island, Study, Gourmet Kitchen

ABOUT:

The Belton opens to a wide foyer with optional luxe tray ceilings and convenient access to the flex room/study at the front of this home. The open kitchen-living-dining room offers 2 fireplace options for a cozy ambiance. The large kitchen boasts generous cabinetry and surface space with a large center island. Privately tucked away at the rear of this home is a large primary suite with a secluded hallway entry. The en suite includes dual vanities, a separate soaker tub, linen closet and private commode. Two secondary bedrooms with walk-in closets are separated by a bathroom and hallway with a linen closet.



ELEVATION A



ELEVATION B



ELEVATION C



FIRST FLOOR

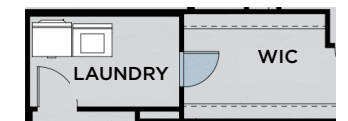
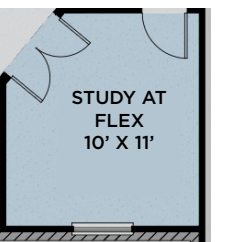
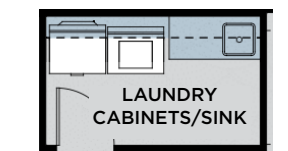
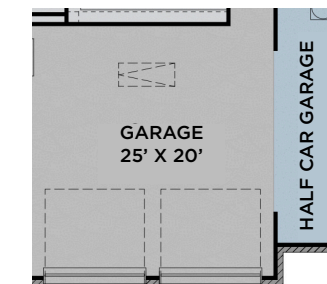
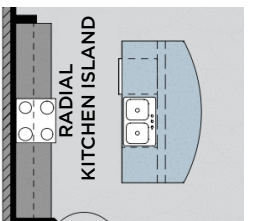
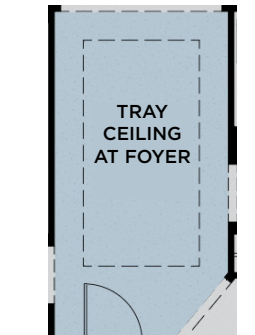
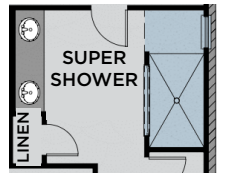
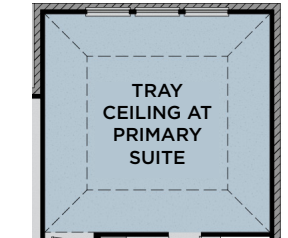
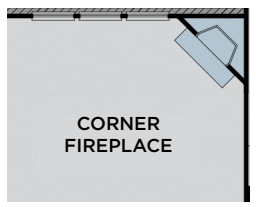
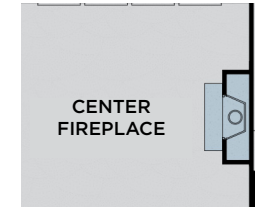
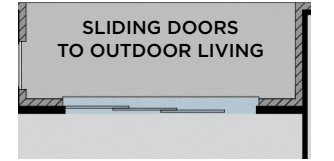
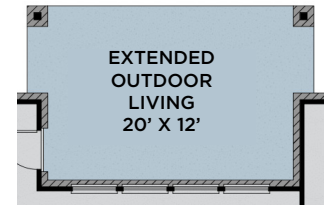

Primary Closet Door to Laundry

Prices, plans, dimensions, features, specifications, materials or availability of homes or communities are subject to change without notice or obligations. Illustrations are artist's depictions only and may differ from completed improvements. Copyright 2025 UnionMain Homes. All Rights Reserved.

CAMERON

PLAN #5110 | 2,491 SQFT



4 Bed



3-3.5 Bath



1 Story



2 Garage

UPGRADE OPTIONS:

Extended Outdoor Living, Outdoor Fireplace, Indoor Corner Fireplace, Tray Ceilings at Foyer, 9' Sliding Doors, Study, Optional Powder Bath, Mud Bench, Gourmet Kitchen, Super Pantry, Built-In Laundry Cabinets, Super Shower, Free Standing Tub Primary Bath

ABOUT:

The Cameron is the ultimate one-story living plan. The welcoming entry and foyer open into the spacious dining room, great room, and desirable covered patio beyond. The well-designed kitchen overlooks a bright dining area and is equipped with a large center island with breakfast bar, plenty of counter and cabinet space, and a roomy pantry. The lovely primary suite is highlighted by a tray ceiling, huge dual closets and spa-like master bath with dual-sink vanity, luxe glass-enclosed shower, and linen storage. The secondary bedrooms feature roomy closets and a shared full hall bath. Additional highlights include a versatile study off the foyer, centrally located laundry, and a powder bathroom.



ELEVATION A



ELEVATION B



ELEVATION C



FIRST FLOOR

Prices, plans, dimensions, features, specifications, materials or availability of homes or communities are subject to change without notice or obligations. Illustrations are artist's depictions only and may differ from completed improvements. Copyright 2025 UnionMain Homes. All Rights Reserved.

DAWSON

PLAN #5120 | 2,553 SQFT



3-5 Bed



2.5-4 Bath



1 Story



2-3 Garage

UPGRADE OPTIONS:

Extended Outdoor Living, Outdoor Fireplace, Outdoor Kitchen, Indoor Corner Fireplace, Sliding Doors to Outdoor Living, Radial Island, Gourmet Kitchen, Tray Ceiling at Foyer, Bedroom 4 w/ Bath 3, Guest Suite w/ Bath 4, Media Room, Flex Room, Office, Study, Primary Bathtub, Super Shower, Primary Bath Barn Doors, Mud Bench, Built-In Laundry Cabinets, Powder Cabinet

ABOUT:

The spacious and inviting family room of the Dawson welcomes you home each night in style. The large kitchen is also very warm, with plenty of space for cooking and even more room to enjoy meals in the large breakfast area. Casual elegance is a hallmark of this home. The foyer offers a view of the stunning outdoor living area. The living and breakfast rooms, conveniently located adjacent to one another, create an ideal space for entertaining. The expansive kitchen includes a large center island, generous counter space, a built-in desk, a walk-in pantry, a large breakfast area and access to the spacious family room, which includes a high ceiling. The master bedroom offers a large walk-in closet as well as a private bath with dual-sink vanity, a luxe super shower and a private toilet area. This home also features nine-foot to eleven-foot ceilings throughout, as well as spacious secondary bedrooms with large closets and full secondary bath.



ELEVATION A



ELEVATION B



ELEVATION C

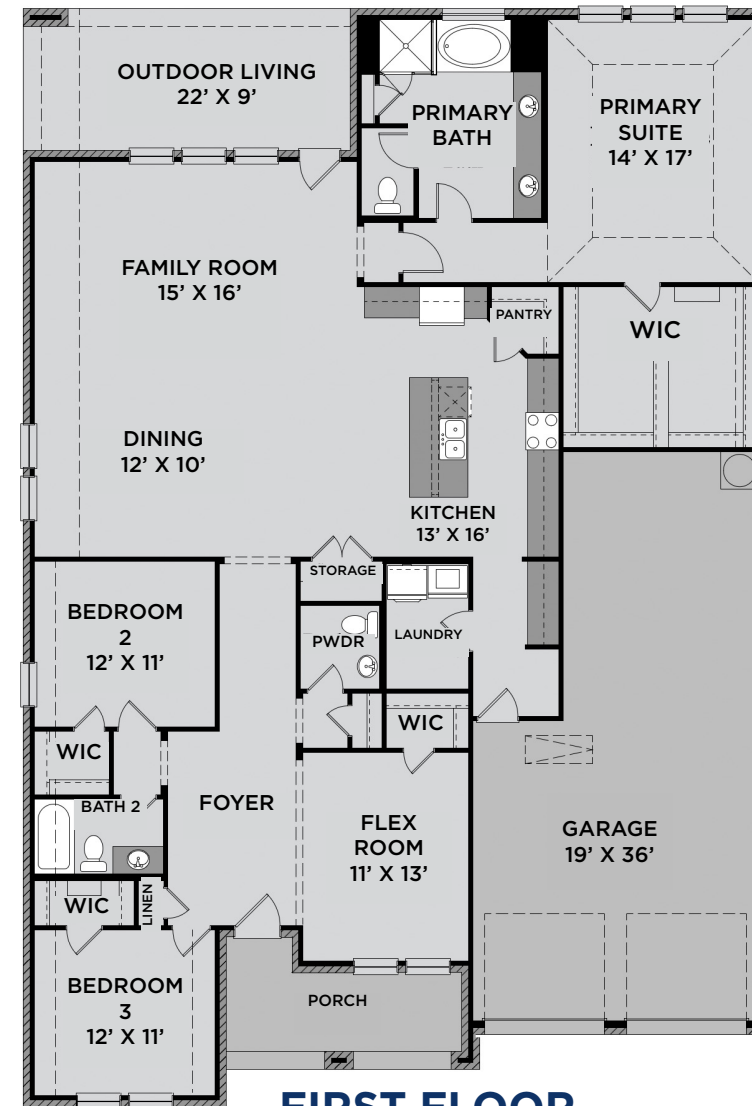

FIRST FLOOR

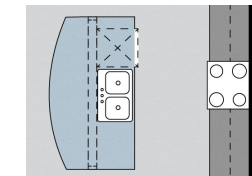
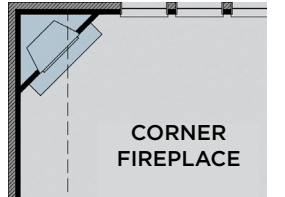
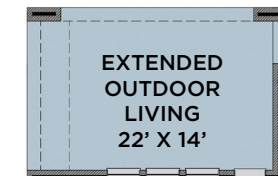

RADIAL ISLAND

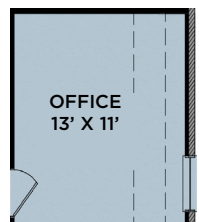
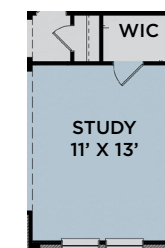
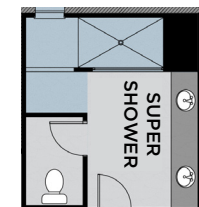
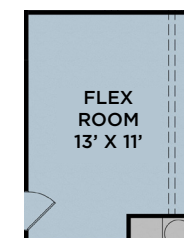
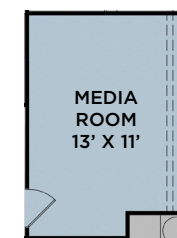
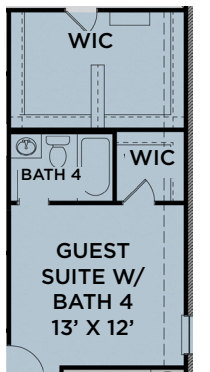
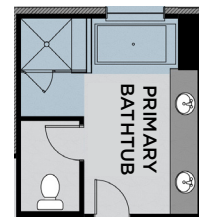

Prices, plans, dimensions, features, specifications, materials or availability of homes or communities are subject to change without notice or obligations. Illustrations are artist's depictions only and may differ from completed improvements. Copyright 2025 UnionMain Homes. All Rights Reserved.

HAWKINS

PLAN #B5130 | 2,700 SQFT



4 Bed



3.5 Bath



1 Story



2-3 Garage

UPGRADE OPTIONS:

Half Car Garage/Single Door Option, Pedestrian Garage Door, Extended Outdoor Living, Sliding Doors to Outdoor Living, Indoor Center/Corner Fireplace, Tray Ceilings at Primary Suite/Foyer, Primary Closet Door to Laundry, Built-In Laundry Cabinets/Sink, Mud Bench, Primary Bath Barn Door, Super Shower, Study, Gourmet Kitchen, Radial Kitchen Island

ABOUT:

The Hawkins is the ultimate high-functioning single story floorplan for modern families. Featuring an elongated foyer with secondary bedroom access and a convenient powder bathroom ideally located for entertaining. A marvelous study at the end of the foyer overlooks the dining and living spaces with optional French doors. The large open-concept kitchen features an expansive island, an Energy Star stainless steel appliance package, and an oversized walk-in pantry tucked to the side. The secluded primary suite with optional tray ceilings is located at the rear of this home, and features a double vanity and generously.



ELEVATION A



ELEVATION B



ELEVATION C

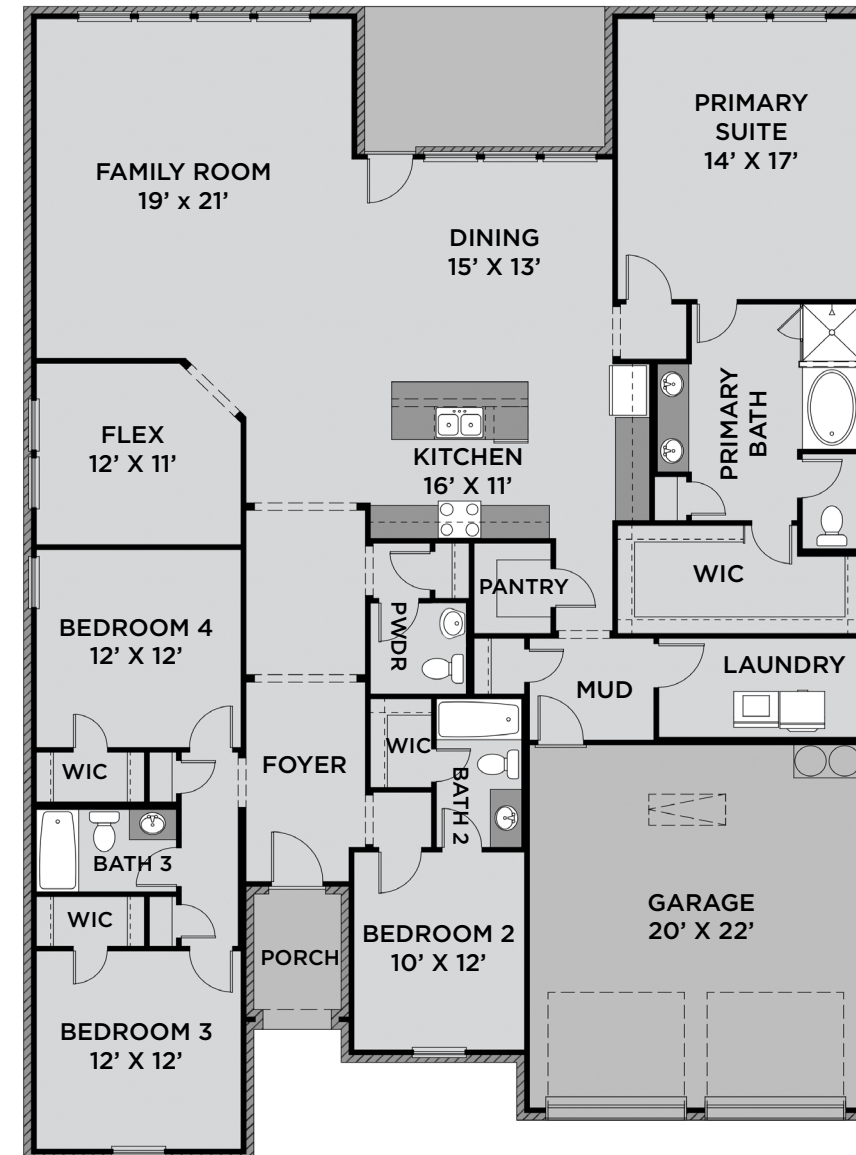

FIRST FLOOR

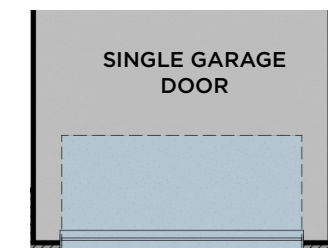
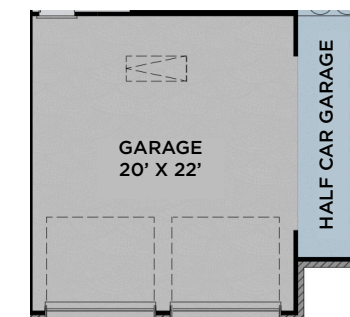
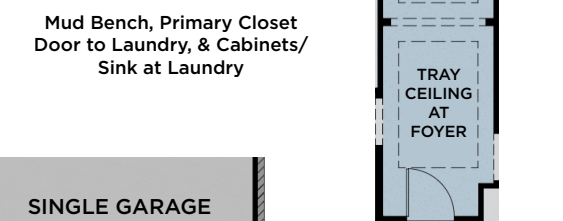
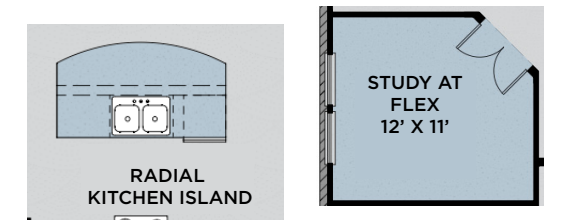
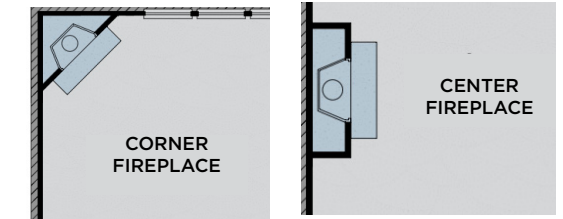
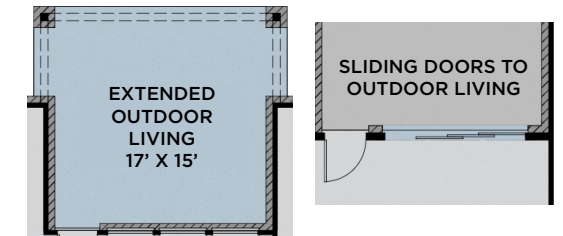

Prices, plans, dimensions, features, specifications, materials or availability of homes or communities are subject to change without notice or obligations. Illustrations are artist's depictions only and may differ from completed improvements. Copyright 2025 UnionMain Homes. All Rights Reserved.

MASON

PLAN #5130 | 2,792 SQFT



3-4 Bed



3-3.5 Bath



1-1.5 Story



2-3 Garage

UPGRADE OPTIONS:

Extended Outdoor Living, Outdoor Fireplace, Sliding Doors, Indoor Center/Corner Fireplace, Tray Ceiling at Foyer, Built-In Dining Cabinets, Mud Bench, Media Room, Flex Room, Built-in Laundry Cabinets, Primary WIC Door to Laundry, Guest Suite w/ Opt. Kitchenette, Radial Island, Gourmet Kitchen, Barn Door at Primary Bath, Super Shower, Super Closet, Opt. Second Floor Bonus Room w/ Powder Bath

ABOUT:

Intimate and sophisticated living. Mason's welcoming covered entry leads to the inviting foyer and beautiful massive great room, with a view to the outdoor living space beyond. The well-equipped gourmet kitchen features ample cabinet space, a desirable walk-in pantry, center island with breakfast bar, and well-lit dining area. The open living kitchen connects to the perfect entertaining dining room and great room. The completely private primary bedroom is complemented by a soaring coffered ceiling, large window wall, a massive walk-in closet, and a luxuriously large bathroom with dual-sink vanity, luxe shower, and private water closet. Additional highlights include three secondary bedrooms with two additional full baths.



ELEVATION A



ELEVATION B



ELEVATION C

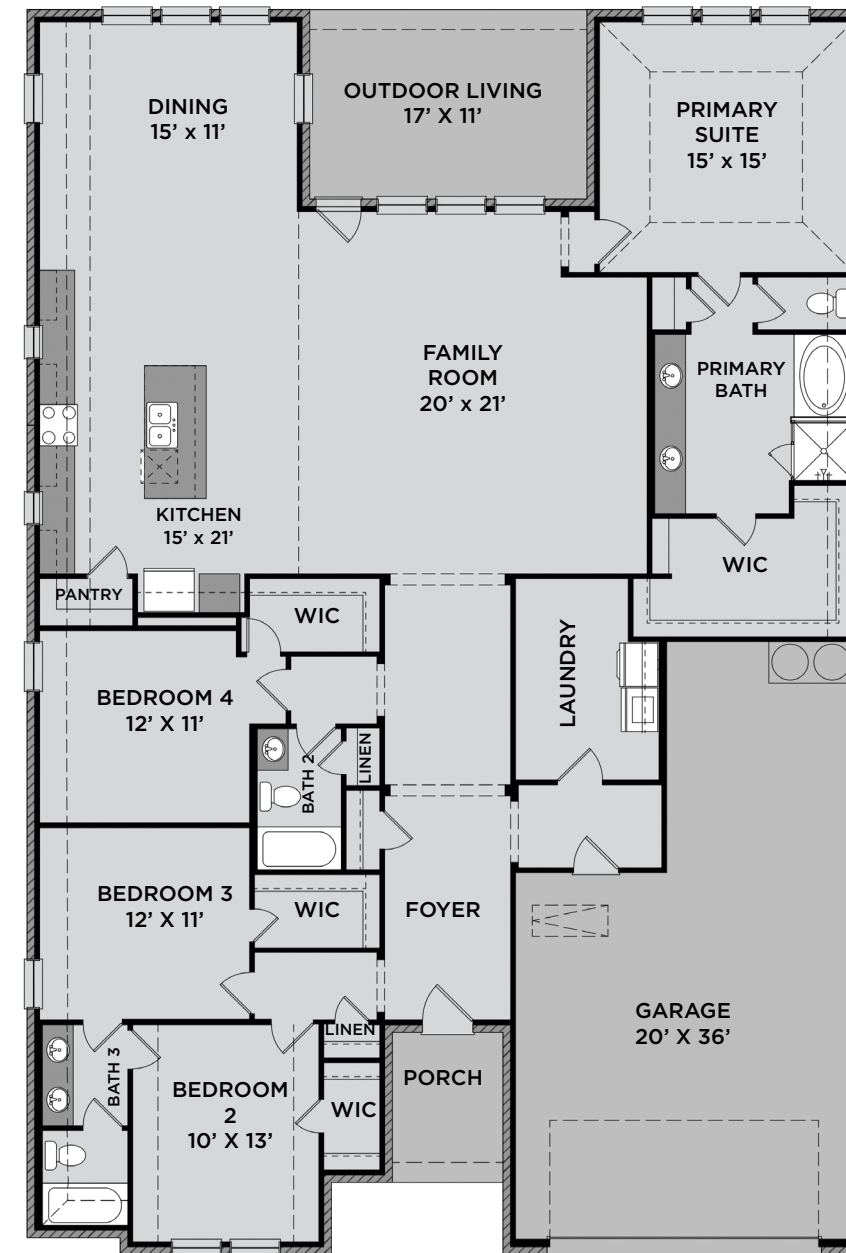

FIRST FLOOR

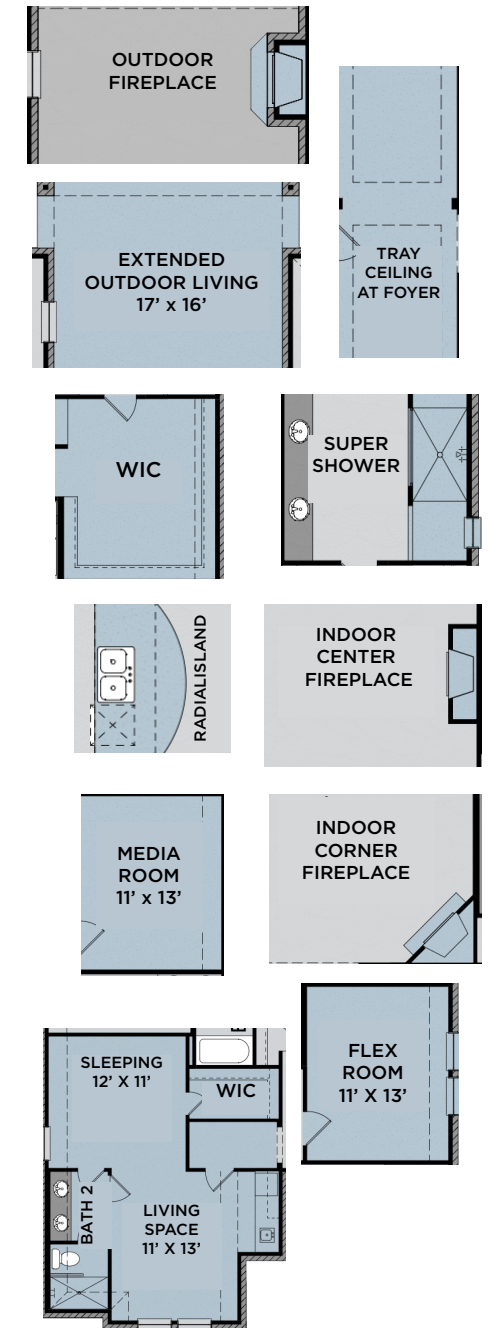

OPTIONAL SECOND FLOOR BONUS ROOM



Prices, plans, dimensions, features, specifications, materials or availability of homes or communities are subject to change without notice or obligations. Illustrations are artist's depictions only and may differ from completed improvements. Copyright 2025 UnionMain Homes. All Rights Reserved.

TRAVIS

PLAN #5140 | 2,843 SQFT



4 Bed



2.5-3.5 Bath



1 Story



3 Garage

UPGRADE OPTIONS:

Garage Pedestrian Door, Gourmet Kitchen, Indoor Center Fireplace, Media Room at Flex, Tray Ceiling Entryway, Powder Bath Cabinet, Built-In Laundry Cabinets, Additional Full Bathroom 3 at Bedroom 3

ABOUT:

Designed for effortless flow and comfortable everyday living, the Travis features an open-concept plan anchored by a spacious family room that seamlessly connects to the dining area and modern kitchen. The kitchen includes a large center island, ample cabinetry, and a walk-in pantry — perfect for hosting or meal prepping with ease. A private primary suite sits at the back of the home and offers a relaxing space complete with an oversized walk-in closet and a luxurious bath featuring dual vanities and a walk-in shower. At the front of the home, two secondary bedrooms combined with a retreat share a full bath, while a versatile flex room offers space for a study or media room. A centrally located laundry room, mudroom and three-car tandem garage complete this lovely single-story home.



ELEVATION A



ELEVATION B



ELEVATION C



ELEVATION D

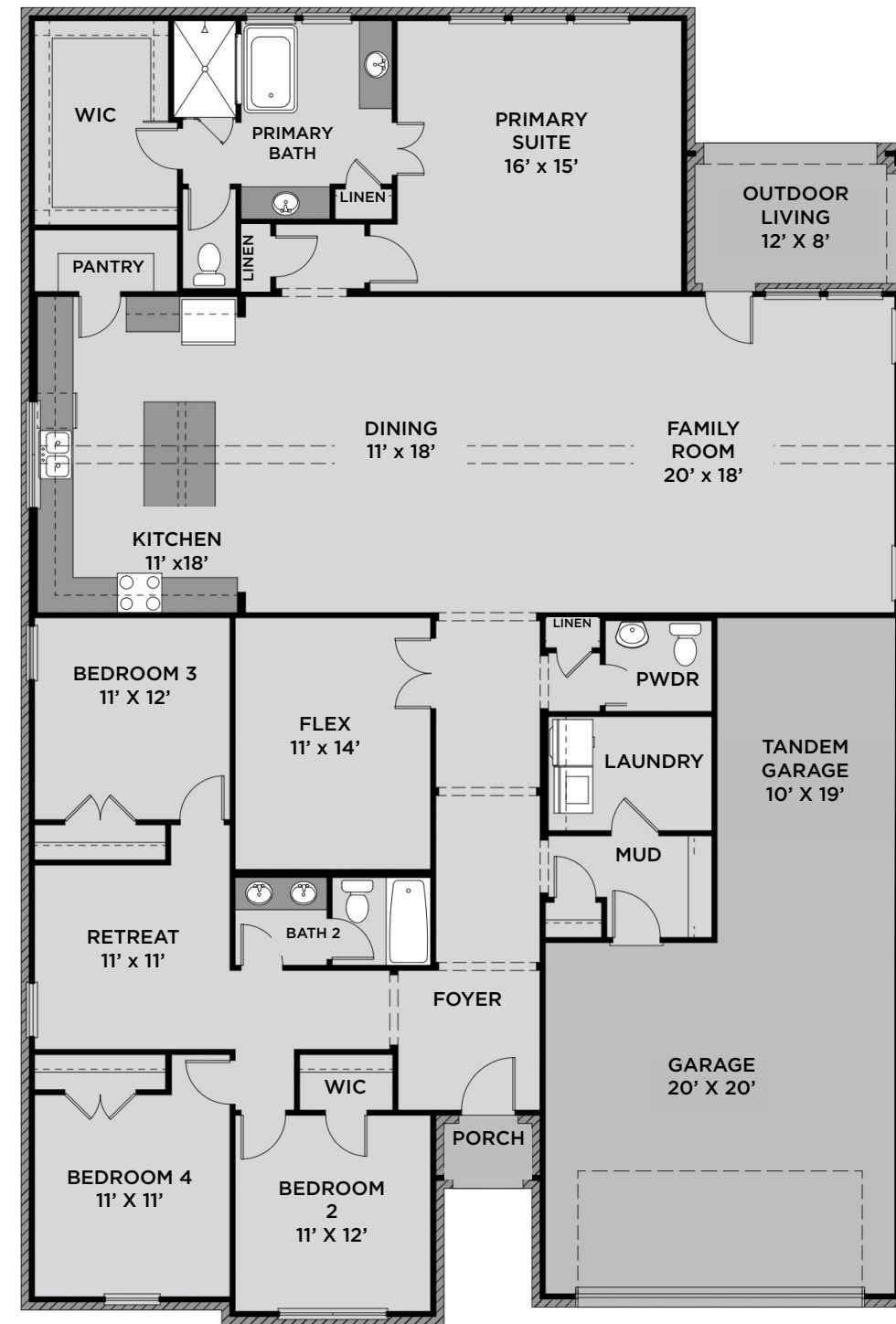

FIRST FLOOR

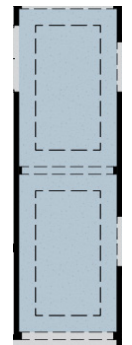
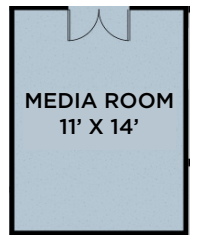
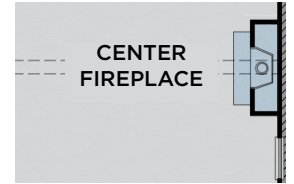

Tray Ceiling Entryway



Powder Bath Cabinet

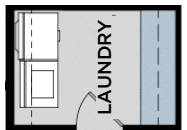

Laundry Cabinets

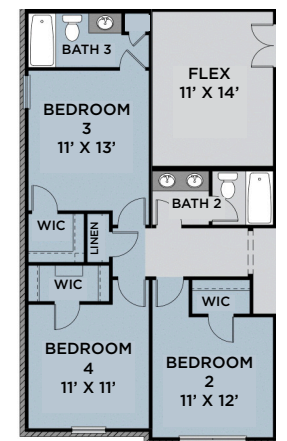

Layout with Additional Bath 3 at Bed 3

Prices, plans, dimensions, features, specifications, materials or availability of homes or communities are subject to change without notice or obligations. Illustrations are artist's depictions only and may differ from completed improvements. Copyright 2025 UnionMain Homes. All Rights Reserved.

JACKSON

PLAN #5135 | 2,931 SQFT



4 Bed



3-3.5 Bath



1 Story



3 Garage

UPGRADE OPTIONS:

Extended Outdoor Living, Outdoor Fireplace, Sliding Doors, Indoor Center/Corner Fireplace, Formal Dining w/ Opt. Tray Ceiling, Tray Ceiling at Foyer, Optional Powder Bath, Mud Bench, Built-In Laundry Cabinets, Gourmet Kitchen, Media Room, Guest Suite, Study, Free Standing Tub Primary Bath, Super Shower

ABOUT:

Upon entering this home, a dynamic study space is adjacent to two full bedrooms with walk-in closets and a full bath. Located off the foyer is a mudroom, laundry room, and garage access. Continue down the hallway into the open living areas including the family room, dining room and kitchen. The kitchen comes with stainless steel appliances, a large island, and a walk-in pantry. Nearby the family room is a dynamic space perfect for a media or formal dining room. The primary bedroom is bright and open with luxe tray ceilings. The bathroom features a large tub and walk-in shower, double vanities, and an oversized walk-in closet. This floor plan is a single story home that offers an optional guest suite as well as other upgrades.



ELEVATION A



ELEVATION B



ELEVATION C

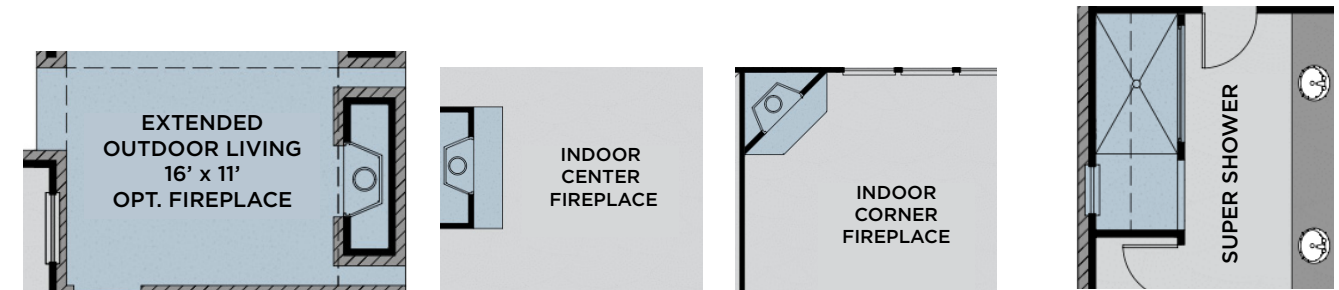

FIRST FLOOR

Prices, plans, dimensions, features, specifications, materials or availability of homes or communities are subject to change without notice or obligations. Illustrations are artist's depictions only and may differ from completed improvements. Copyright 2025 UnionMain Homes. All Rights Reserved.

KIRBY

PLAN #B5240 | 3,045 SQFT



4-5 Bed



2.5-4 Bath



2 Story



2 Garage

UPGRADE OPTIONS:

Pedestrian Garage Door, Extended Outdoor Living, 9'/12' Sliding Doors, Indoor Center/Corner Fireplace, Barn Door at Primary Bath, Super Shower, Bedroom 5 w/ Bath 3 ILO Flex, Powder Bath Cabinet, Built-In Laundry Cabinets, Additional Dining Windows, Gourmet Kitchen, Radial Island, Mud Bench, Study, Open Railings, Additional Bath 4, Media Room, Window Seating in Game Room

ABOUT:

Discover seamless living and entertaining with the Kirby plan. The Kirby is a beautifully open 2-story floor plan featuring a large kitchen with an island overlooking the family room. An elongated grand entry features a first-floor flex space or home office. The secluded primary suite features a luxe tray ceiling and oversized windows. A spacious primary bathroom with double vanities, an enclosed toilet, and a giant walk-in closet complete the space. A convenient storage closet is located underneath the staircase that transitions into an enormous game room with views of below. Included upstairs are three bedrooms that share a dual-vanity bathroom.



ELEVATION A



ELEVATION B



ELEVATION C

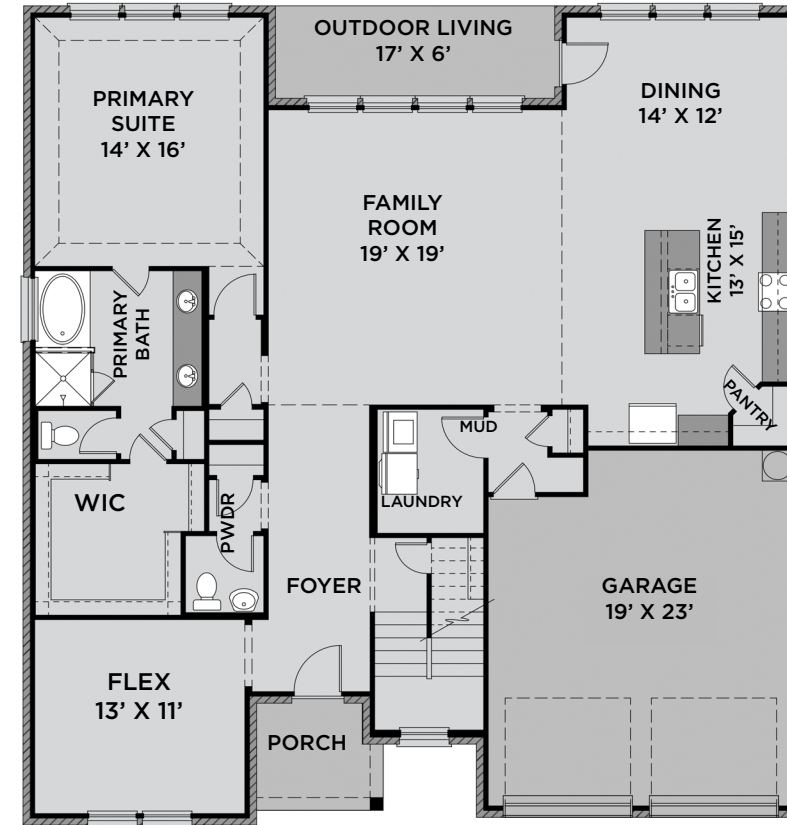

FIRST FLOOR



SECOND FLOOR

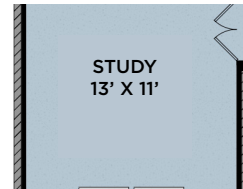
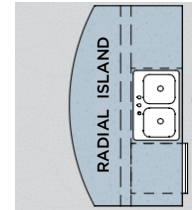
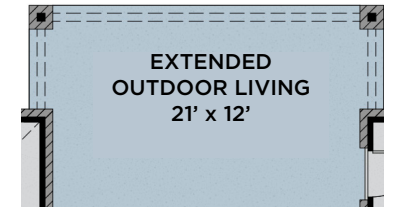

OPEN TO BELOW

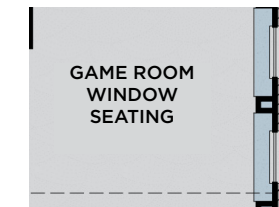
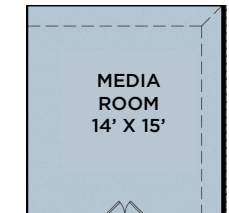
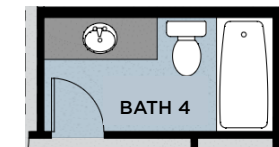

Prices, plans, dimensions, features, specifications, materials or availability of homes or communities are subject to change without notice or obligations. Illustrations are artist's depictions only and may differ from completed improvements. Copyright 2025 UnionMain Homes. All Rights Reserved.

GRAYSON

PLAN #5250 | 3,347 SQFT



4-5 Bed



3-4.5 Bath



2 Story



2-3 Garage



ELEVATION A



ELEVATION B



ELEVATION C

UPGRADE OPTIONS:

Pedestrian Garage Door, Extended Outdoor Living, Outdoor Fireplace, Indoor Center/Corner Fireplace, 9'/12' Sliding Doors, Barn Door at Primary Bath, Super Shower, Free Standing Tub Primary Bath, Media Room Downstairs/Upstairs, Study, Workout Room w/ Closet, Gourmet Kitchen, Radius Island, Mud Bench, Built-In Laundry Cabinets, Guest Suite, Additional Bath 4, Additional Bed 5 w/ Bath 4, Optional Powder Bath

ABOUT:

The open dining room of the intricate Grayson is enhanced by a large expanse of sun-filled windows and includes a view of the grand staircase. The spacious family room and open kitchen is the perfect place for entertaining. The private primary bedroom features several windows and a tray ceiling, along with a spa-like bath with dual sinks and luxe super shower. All secondary bedrooms include a walk-in closet and private bath. Other highlights include a first-floor secondary bedroom, and a spectacular kitchen with a large walk-in pantry, center island, and roomy breakfast area. The upstairs features a spacious game room, optional media room, two additional bedrooms, and a full bath.

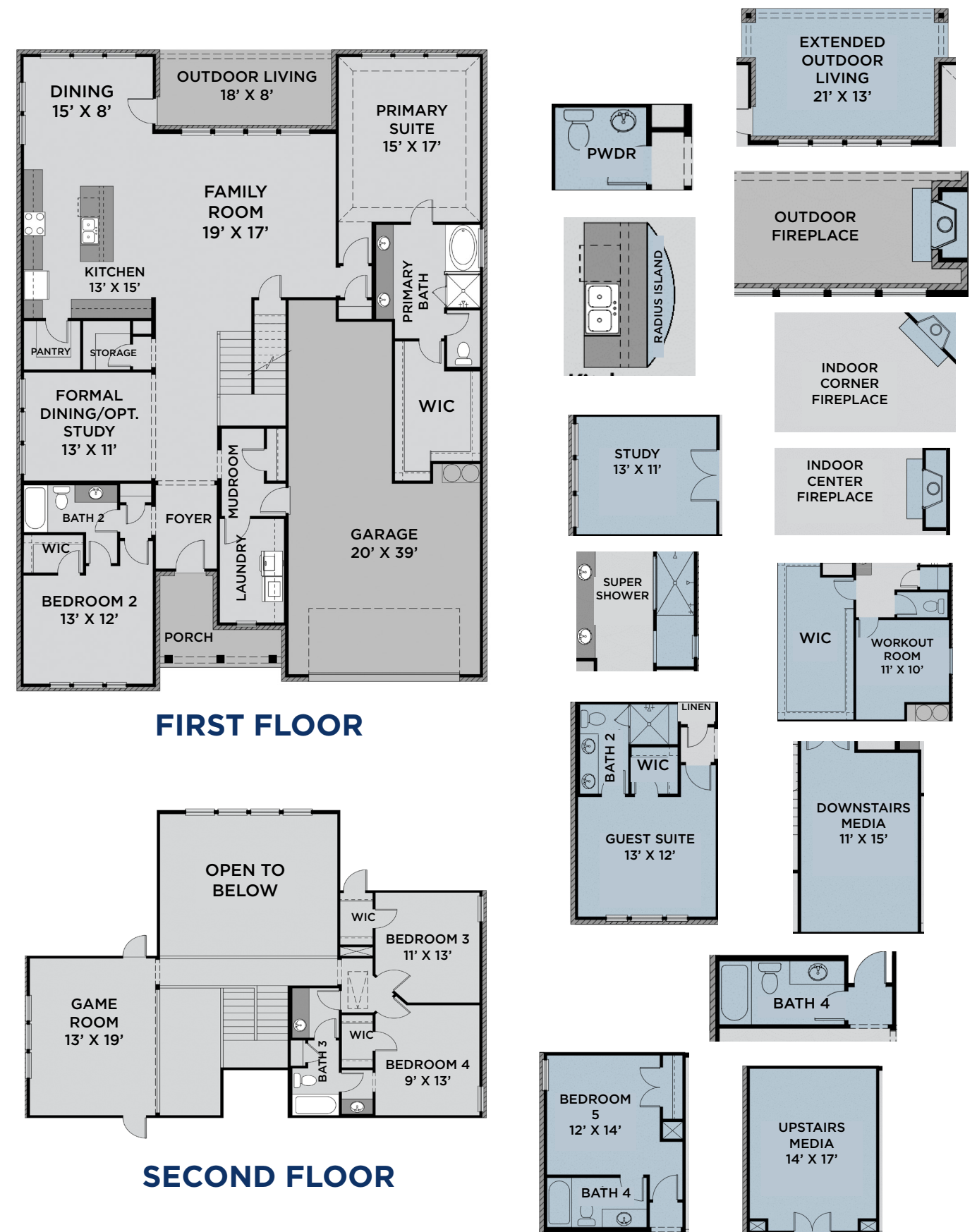

Prices, plans, dimensions, features, specifications, materials or availability of homes or communities are subject to change without notice or obligations. Illustrations are artist's depictions only and may differ from completed improvements. Copyright 2025 UnionMain Homes. All Rights Reserved.

PRESIDIO

PLAN #5240 | 3,668 SQFT



5 Bed



4.5 Bath



2 Story



2-3 Garage

UPGRADE OPTIONS:

Garage Pedestrian Door, Double Garage Doors, Extended Outdoor Living, 12' Sliding Doors, Gourmet Kitchen, Powder Bath Cabinet, Built-In Laundry Cabinets, Downstairs Media Room, Upstairs Media Room, Bonus Room, Formal Dining

ABOUT:

Welcome to the thoughtful and spacious Presidio plan. Enter from the covered porch into a bright foyer with a study just off the entry, perfect for working from home. A secondary bedroom at the front of the home includes its own full bath and walk-in closet. Continue down the hall past a powder bath, mudroom, and laundry. The kitchen features a large island, walk-in pantry, and opens to a casual dining nook with access to the covered outdoor living area. The family room offers plenty of space to relax or entertain. The private primary suite includes a spacious walk-in closet and a luxe bath with dual vanities and a large walk-in shower. Upstairs, a game room anchors three secondary bedrooms. Bedroom 3 has its own full bath, while bedrooms 4 and 5 share a bath with separate vanities.



ELEVATION A



ELEVATION B



ELEVATION C

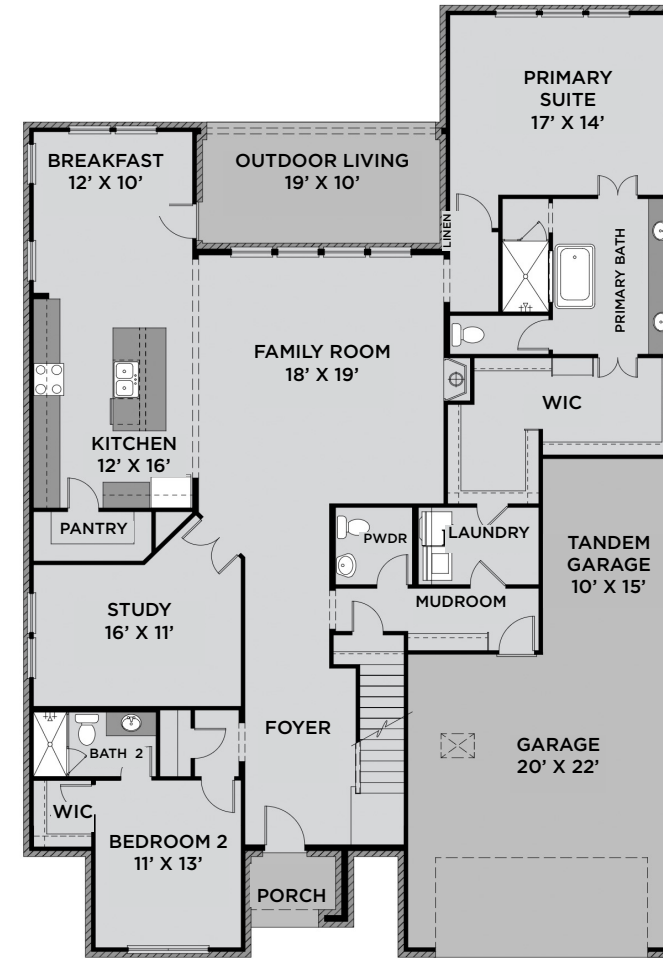

FIRST FLOOR

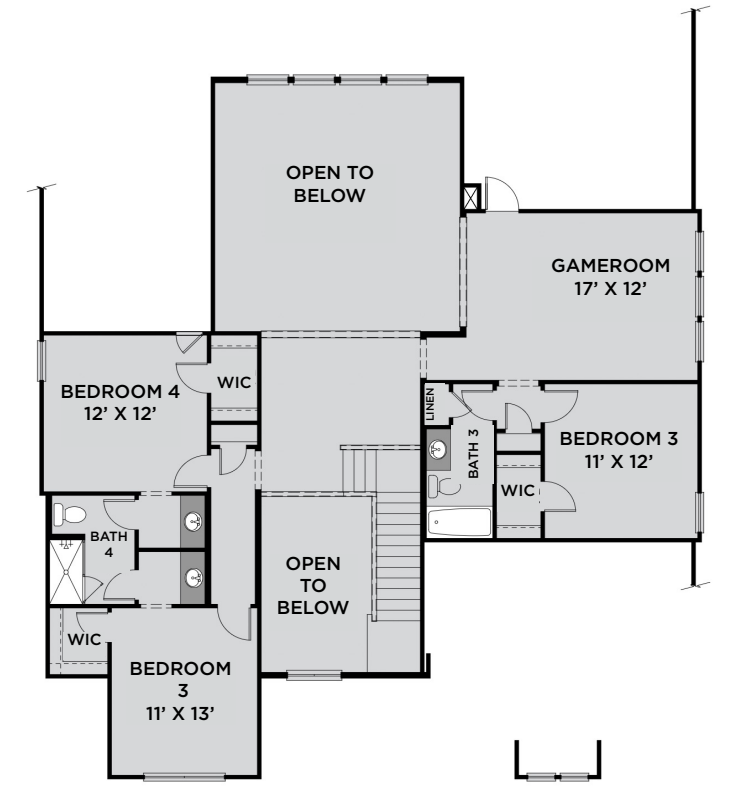

SECOND FLOOR

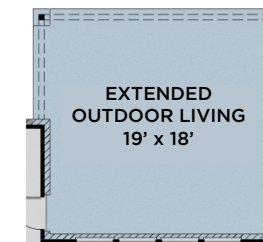
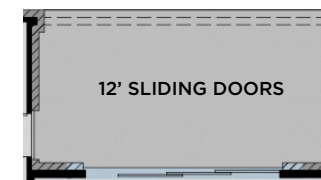

Built-In Laundry Cabinets

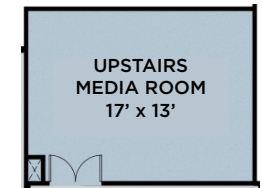

UPSTAIRS MEDIA ROOM
17' x 13'

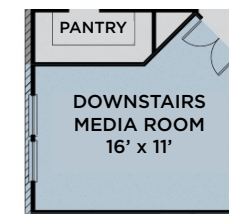

DOWNSTAIRS MEDIA ROOM
16' x 11'

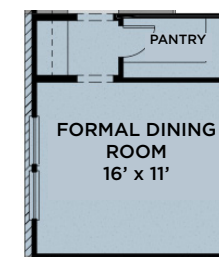

FORMAL DINING ROOM
16' x 11'



Powder Bath Vanity Cabinet

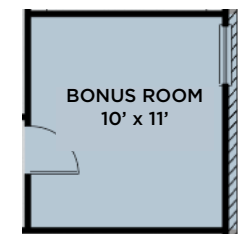

BONUS ROOM
10' x 11'

Prices, plans, dimensions, features, specifications, materials or availability of homes or communities are subject to change without notice or obligations. Illustrations are artist's depictions only and may differ from completed improvements. Copyright 2025 UnionMain Homes. All Rights Reserved.

WHITNEY

PLAN #B5260 | 3,448 SQFT



4-5 Bed



3.5-4.5 Bath



2 Story



2 Garage

UPGRADE OPTIONS:

Single Garage Door, Pedestrian Garage Door, Extended Outdoor Living, 12' Sliding Doors, Additional Breakfast Windows, Built-In Laundry Cabinets, Powder Cabinets, Indoor Center/Corner Fireplace, Tray Ceiling at Foyer, Mud Bench, Tray Ceiling at Primary Suite, Super Shower, Barn Door at Primary Bath, Primary WIC Door to Laundry, 2 Study Options, Open Railings, Additional Bath 4, 2 Media Options

ABOUT:

The Whitney's cozy front porch opens to an elongated foyer with a marvelous flex room at the front of the home. Located near the formal dining space, the open kitchen and living area features an expansive island, stainless steel appliances, and an oversized walk-in pantry. Tucked away near the staircase is a long, private hallway that extends towards the primary suite with backyard views. The primary suite is complete with a double vanity, enclosed toilet, and generously sized walk-in closet. Upstairs, a large game room, three full bedrooms with walk-in closets, and a full bath, with option for a media room and/or additional full bath.



ELEVATION A



ELEVATION B



ELEVATION C

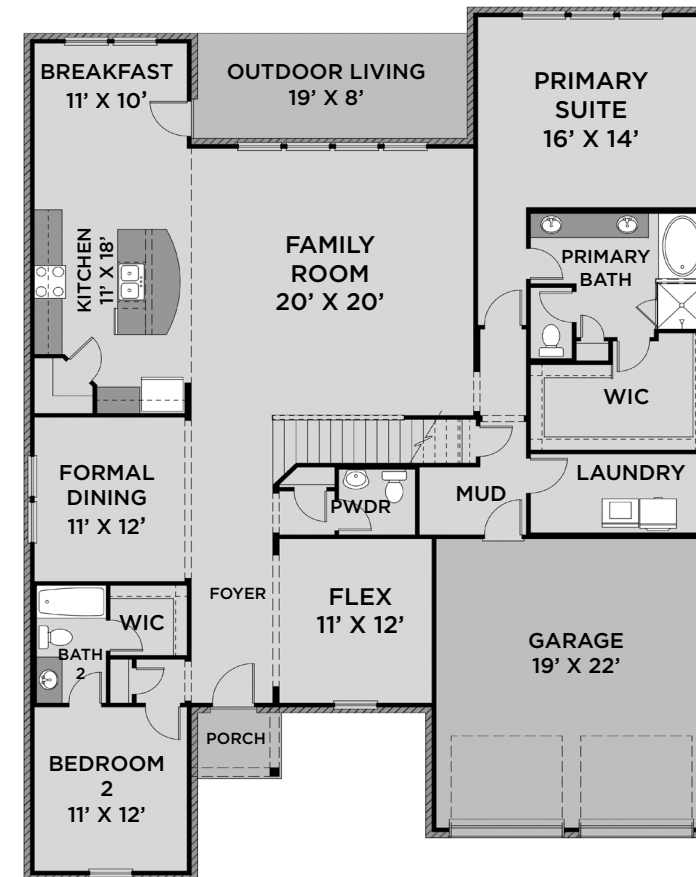

FIRST FLOOR

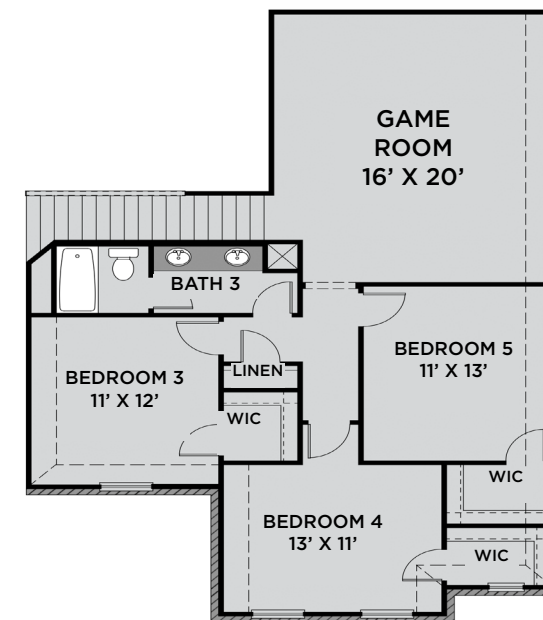

SECOND FLOOR

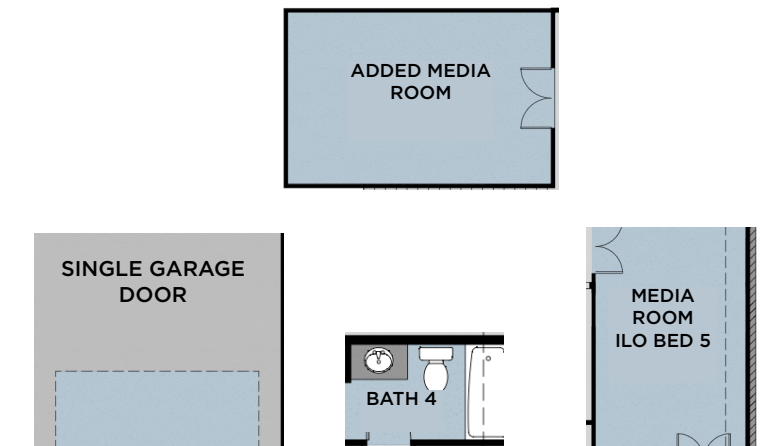
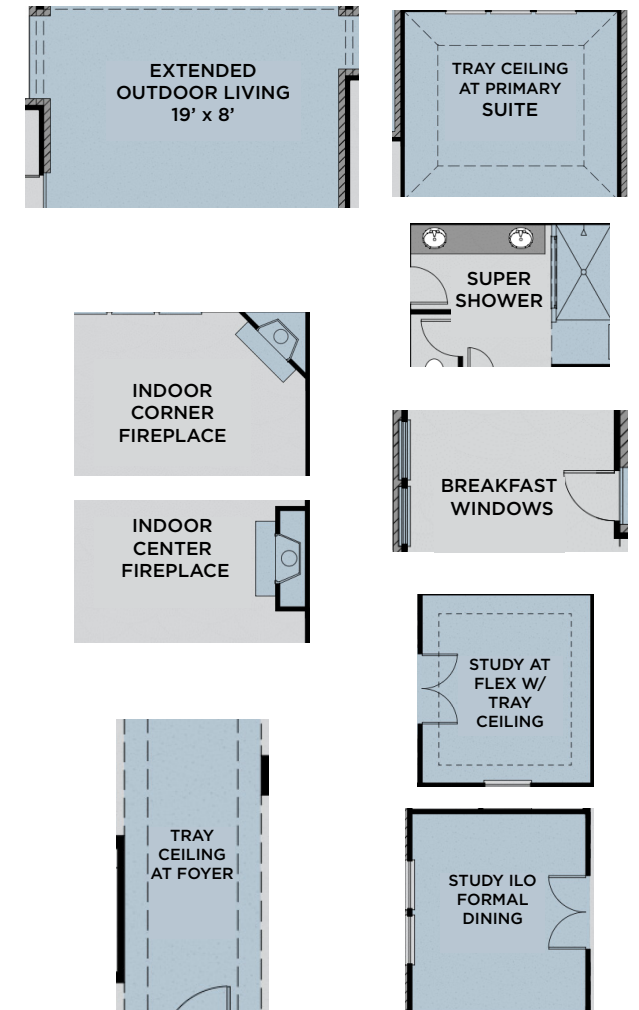

Prices, plans, dimensions, features, specifications, materials or availability of homes or communities are subject to change without notice or obligations. Illustrations are artist's depictions only and may differ from completed improvements. Copyright 2025 UnionMain Homes. All Rights Reserved.

EASTLAND

PLAN #5270 | 3,948 SQFT



5 Bed



4.5 Bath



2 Story



2-3 Garage



ELEVATION A



ELEVATION B



ELEVATION C

UPGRADE OPTIONS:

Extended Outdoor Living, Sliding Doors to Outdoor Living, Formal Dining at Flex, Downstairs Media Room at Flex, Radial Kitchen Island, Exercise Room, Primary WIC Door to Laundry, Built-In Laundry Cabinets (opt. sink), Mudbench, In-Law Suite in lieu of Study (opt. door to porch) Upstairs Media Room, Gourmet Kitchen

ABOUT:

Welcome to the stately and grand Eastland plan. Enter through the covered front porch into a welcoming foyer. You're met with a quiet study with french doors for privacy from the rest of the first floor. A bedroom is at the front of the home with its own full bath and walk-in closet. Down the hall is a convenient powder bath, laundry and mudroom. Before the great room is a flex space tucked in a corner – perfect place for formal dining or a media room. A sparkling kitchen complete with a pantry, island, and plenty of storage overlooks a breakfast nook with access to covered outdoor living. The primary suite boasts a vaulted ceiling with optional exposed beams, an opulent bathroom with his and hers vanities, and spacious walk-in closet. Upstairs includes a loft space, gameroom, and three other bedrooms. Beds 2 and 3 share a Jack-and-Jill bath, and bed 4 has its own full bath.

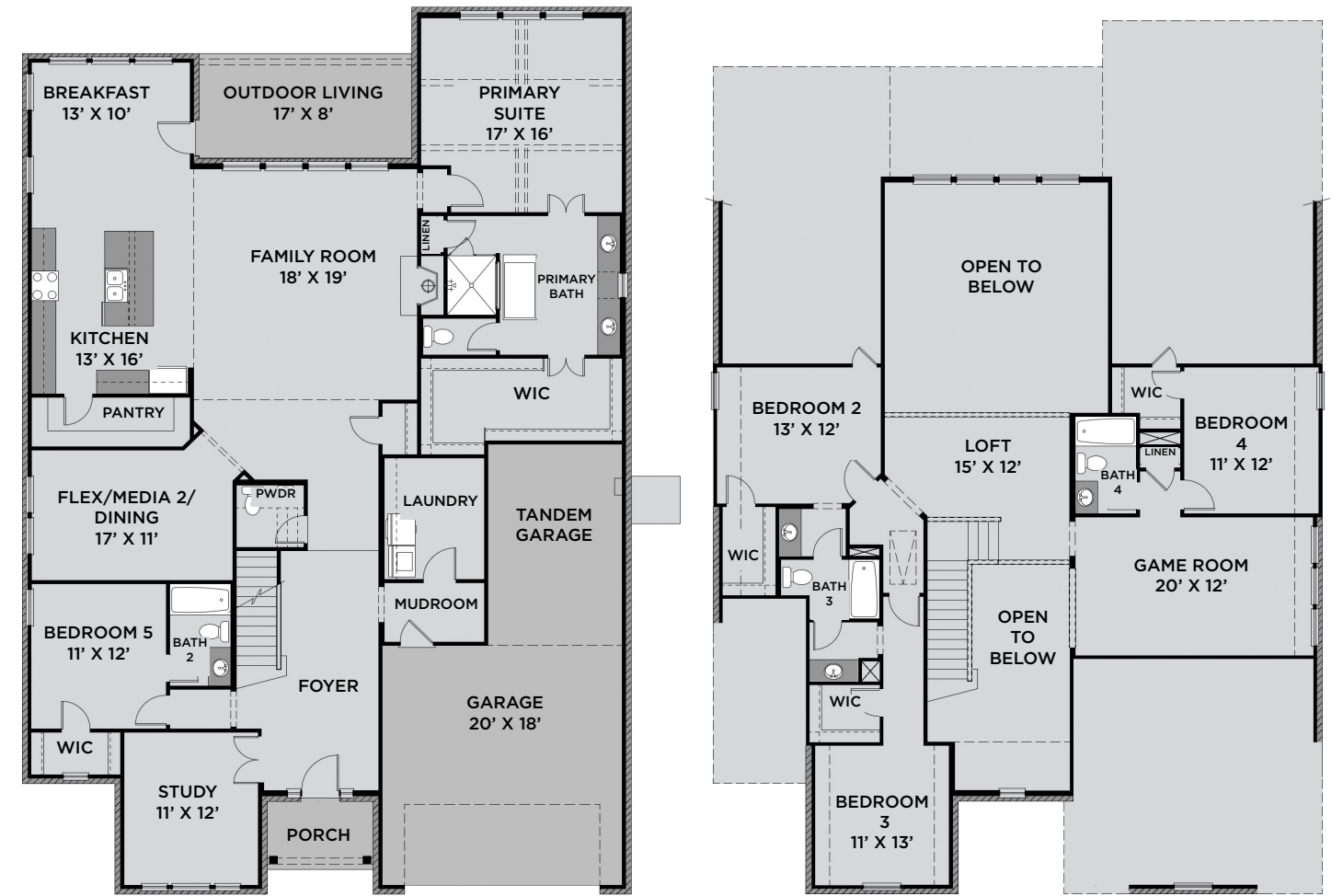

FIRST FLOOR

SECOND FLOOR

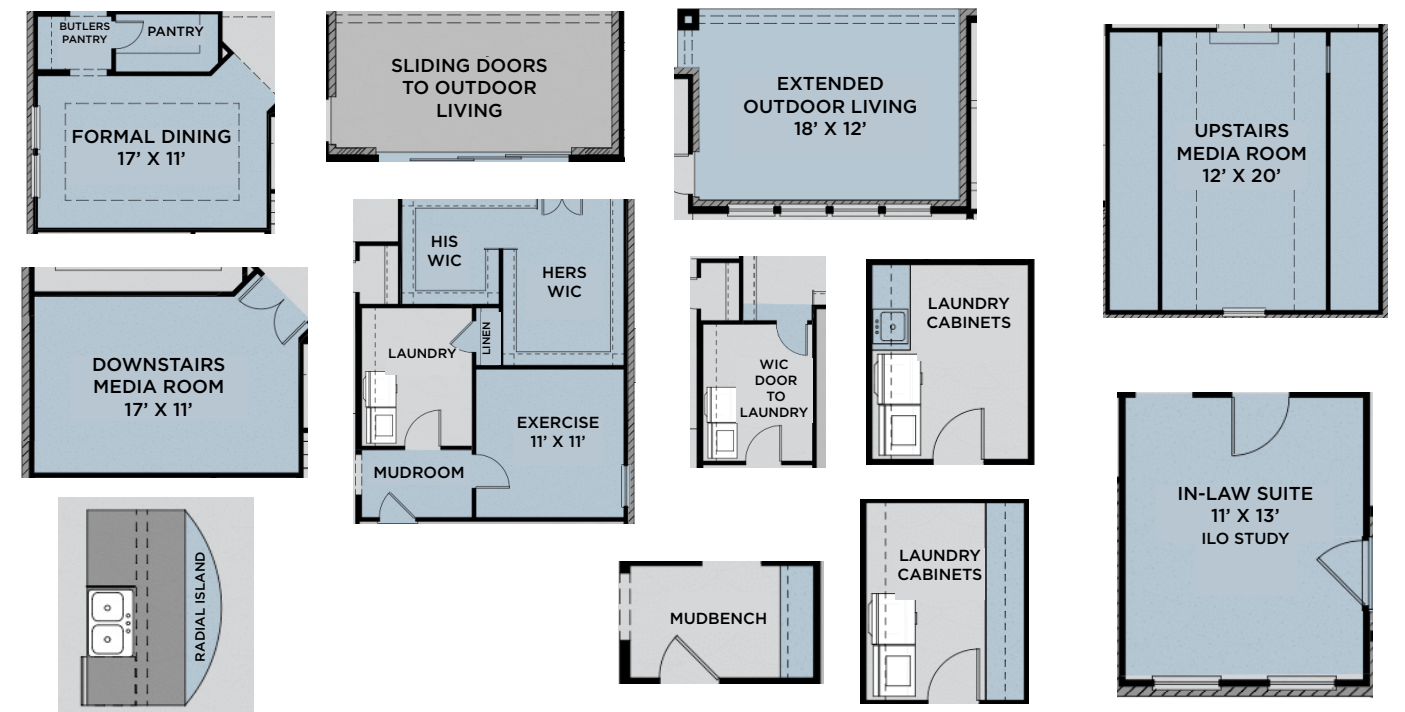

Prices, plans, dimensions, features, specifications, materials or availability of homes or communities are subject to change without notice or obligations. Illustrations are artist's depictions only and may differ from completed improvements. Copyright 2025 UnionMain Homes. All Rights Reserved.

MYRTLE CREEK INCLUDED FEATURES



EXTERIOR DESIGN FEATURES

- Elegant exterior elevations
- Full Brick Front Porch
- 8' front door with decorative Kwikset handleset with keyless entry
- Clay brick (all four sides) and stone elevations with buff mortar (per plan)
- Front and back yard irrigation system with rain and freeze sensors
- Landscape package including seasonal shrubs, full sod and one tree
- 6' stained privacy fence with metal posts and one gate
- Large covered brick front porch and rear outdoor living (per plan)
- Dimensional high-definition roof shingles with 30-year manufacturer's lifetime warranty
- HardiePlank lap siding with 30-year manufacturer's limited warranty (per plan)
- HardieTrim exterior trim with 15-year manufacturer's limited warranty
- Full gutters whole house
- Two frost resistant hose bibs
- Decorative coach lights (per plan)

INTERIOR DESIGN FEATURES

- Resilient 5-1/4" x 47-1/4" laminate plank flooring in entry halls, kitchen, dining, utility, and family rooms. Available in four designer colors
- Designer 12x12 ceramic tile in all baths
- Rounded corners throughout (excludes windows)
- Kwikset distinctive door hardware in selected finishes
- Crown moulding at entry and extended entry (per plan)
- 5 1/2" baseboard throughout home
- High-quality Scotchgard stain-resistant carpet with 10-year wear limited warranty
- PPG high-quality, low-VOC interior paint in 10 decorator colors for walls and three colors for doors and trim
- Ceiling fan with light kit installed in family room and primary suite
- Game room, bedrooms, study/flex, and patio blocked and wired for ceiling fans
- Decora light switches
- Pedestal sink beveled mirror in powder bath (per plan)
- Site-built shelves and hanging rod above washer & dryer
- Full light patio door
- Raised ceilings (per plan)
- Satin nickel door knobs
- Recessed LED can lights
- 8' Rockport doors on first floor, 6'-8" doors on second floor

PRIMARY SUITE

- Custom full-height, shop-finished vanity cabinets for increased storage
- 1.6 cm counter tops installed at vanities with two under-mount porcelain sinks
- 42" plate glass mirrors with two vanity light fixture
- 42"x42" Walk-in shower with fiberglass shower pan
- Classic garden tub with tile surround (per plan)
- Delta Woodhurst faucet in satin nickel finish
- USB outlet at vanity (per plan)
- Spacious walk-in closets with generous hanging space and wood shelving
- Private commode

KITCHEN DESIGN FEATURES

- Shop-finished cabinets with 42" uppers with crown moulding
- 3-cm granite countertop selection with choice of two included edges
- 60/40 stainless steel under mount sink with designer Essa pull-out faucet by Delta
- Large breakfast island (per plan)
- Full tile backsplash
- GE® stainless steel appliance package with 30" built-in 5-burner gas cooktop, built-in oven, microwave vented to exterior and energy-saving dishwasher
- Phone charging USB outlet (per plan)
- Recessed ice maker connection at refrigerator
- Recessed LED lighting (per plan)
- High capacity 1/3 HP disposal with countertop-mounted air switch (per plan)

LOW VOLTAGE AND SECURITY

- Security system with one keypad at garage door, one siren, one motion detector at family room, one back-up cellular dispatch, contacts on all perimeter operable doors
- Structured wiring control panel in 30" home run cabinet
- Three RG6 ports
- Three CAT5e outlets
- One fiber service conduit directly to control panel
- Smoke and carbon monoxide detectors
- Two USB equipped outlets for easy phone charging

ENERGY SAVINGS AND COMFORT

- High-efficiency 16 SEER certified A/C system with eco-friendly Puron coolant
- Certified Home Energy Rating Systems (HERS) Index calculated per plan
- Dual-zoned AC system in all two-story plans (two thermostats)
- R-6 HVAC ductwork with fresh air intake
- 4" MERV 10 media filters at HVAC units
- Honeywell WIFI enabled programmable thermostat(s)
- R-13 fiberglass batt insulation at 2x4 exterior walls
- R-19 fiberglass batt insulation at 2x6 exterior walls
- R-11 fiberglass batt insulation at media room (per plan)
- R-22 fiberglass batt insulation at vaulted ceilings
- R-22 fiberglass batt insulation at flat ceiling (under decking)
- R-22 fiberglass batt insulation between garage ceiling and living areas
- R-38 fiberglass batt insulation in flat ceilings (no access)
- Polycel foam insulation around all doors, windows and other penetrations, with foam gasket under base plates and sheetrock edges between A/C and non-A/C spaces
- Dual pane Low-E argon gas insulated windows (tilt in for easy cleaning)
- Energy-saving radiant barrier roof decking
- Water-conserving Delta washer-less faucets
- Rheem tankless water heater
- LED energy-saving lighting

QUALITY CONSTRUCTION

- 10-year Limited Structural Warranty
- Two-year Limited Mechanical Delivery System Warranty
- One-year Limited Workmanship and Materials Warranty
- Four customer touchpoint meetings (redline, pre-drywall, new home orientation, house to home sign off)
- Internal quality assurance inspection prior to closing
- Individually engineered post-tension foundations
- Engineered floor framing systems
- Engineered framing and shear walls
- Borate wood treatment for termites
- Finished garages including texture, paint and baseboard
- 2x6 framed walls at plumbing areas (per plan)
- PPG high-quality, low-VOC interior and exterior paint
- Garage door opener with two remotes per door
- Elongated water-conserving commodes
- PEX high-pressure plumbing system with corrosion-resistant fittings above foundation
- Main water shutoff valve in utility room or garage wall
- Gas service lines included at furnace unit(s), optional fireplace and free-standing range



UNIONMAIN HOMES NEW HOMEOWNER'S GUIDE TO SETTING UP UTILITIES

MYRTLE CREEK



To ensure your move goes as smooth as possible, make sure to set up the necessary utilities in your name after your official closing date. Please monitor and update your utilities start date if your closing date changes. Please note that the new homeowner has three business days after closing to transfer utilities into their name.



Electricity

Oncor
(888) 286-6700
oncor.com



Natural Gas

Atmos Energy
(888) 286-6700
atmosenergy.com



Internet, Cable & Phone

AT&T
(800) 321-2000
att.com



Security

HomePro
(844) 661-5777
homeprotech.com



Trash, Water & Sewer

City of Waxahachie
(469) 309-4170
Waste Connections
(972) 289-6714



Police Department

Non-emergency
(469) 309-4400



Fire Department

Non-emergency
(469) 309-4200



Emergency

911



HOA

VCM
(972) 612-2303
vcmtexas.com



10-YEAR LIMITED STRUCTURAL WARRANTY

WE ARE HERE EVERYDAY FOR YOU

HOW TO SUBMIT A WARRANTY REQUEST?

UnionMain Homes is dedicated to promptly responding to your warranty needs. Per our warranty guide please submit your 60 Day Warranty Service Requests and your 11 Month Warranty Service Requests via our website: www.unionmainhomes.com/home-warranty/

FOR EMERGENCY CLAIMS:

A warranty emergency is an event or situation related to the home's performance that creates an imminent threat of serious damage to the home or results in an unsafe living condition.

Emergency service is needed when there is:

- a plumbing leak that requires shutting off the main supply
- a sewer back-up
- a total loss of heating and/or cooling (HVAC) - all units

If you experience a warranty emergency please follow the steps at: www.unionmainhomes.com/emergency-support/.

For more information visit www.UnionMainHomes.com

10 YEAR COVERAGE

on structural elements of the home

2 YEAR COVERAGE

on the workability of plumbing, electrical, HVAC, and other mechanical systems

1 YEAR COVERAGE

on materials and workmanship

Warranty is transferable.

For more information or questions contact your sales counselor.
www.UnionMainHomes.com



Disclosure:

Warranties are transferable to subsequent owner who takes title within the applicable warranty period. Information above is intended only to highlight certain aspects of the warranty. Terms, conditions, exclusions, and limitations apply. Warranty is based on Performance Standards criteria that are set forth in the full warranty. A complete description of warranty terms, conditions, exclusions, and limitations is available at <http://www.unionmainhomes.com>. 10-year structural warranty covers: footings, bearing walls, beams, girders, trusses, rafters, bearings, columns, lintels, posts, structural fasteners, subfloors, and roof sheathing. The photograph depicts a model containing features or designs that may not be available on all homes. © 2025 UnionMain Homes, LLC. All rights reserved. 05/25



COMMUNITY SALES CENTER

MYRTLE CREEK
225 Wintergrass Drive
Waxahachie, TX 75165
Monday thru Saturday (10AM - 6PM)
Sunday (12PM - 6PM)
(469)-813-8700



Learn More About
Myrtle Creek